

# WATER INSTALLATION REQUIREMENTS

## WATER SERVICES

1. Construction Specifications: Building water service construction must adhere to the following requirements:
  - A. All service pipes must be laid with at least one foot (1' 0") of extra length to prevent rupture due to settlement.
  - B. All service pipes must be placed at least seven feet (7'-0") below the surface to prevent rupture by freezing.
  - C. "Type K" copper tubing must be used for all copper services of two inches (2") or less, with no joints in the copper line. The service must remain uncovered until inspected by New Prague Utilities.
  - D. Plastic service lines may only be used if produced with approved bimodal PE 4710 (PE 80) listed resins, with a PPI recommended hydrostatic design basis (HDB) of 1600 psi at 68°F (20°C) and 1000 psi at 176°F (80°C) for elevated temperatures. All compression fittings must be Ford or McDonald CTS fittings or a pre-approved equivalent. The plastic line must be a continuous run to the valve inside the building, with no joints.
  - E. All plastic water services must have a 12-gauge solid core wire strapped to the water line from the curb box cap to the valve in the building. This must be a continuous run of tracer wire with no splicing. If the tracer wire does not work, it must be replaced as a continuous run.
  - F. All plastic lines passing through the concrete floor must be in a vertical position. The water service line and tracer wire must be strapped to the grounding rod provided by New Prague Utilities to maintain the vertical position.
  - G. Only tracer wire shall be grounded to the New Prague Utilities-provided grounding rod.
  - H. Plastic service lines must have a 5-year Florida UV rating.
  - I. All water service pipes must comply with ASTM D-2737, SDR 9 CTS pipe with a pressure rating of 200 psi.
  - J. Service lines over two inches (2") in diameter must be ductile iron pipe or PVC: ANSI/AWWA C900, with dimensions equivalent to DIP and a thickness class of DR-18.
  - K. Connections with water mains for domestic supply must be at least one inch (1") in diameter.

## INSPECTIONS

- A. The installation contractor must notify New Prague Utilities at least 24 hours in advance when the building water service connection is ready for inspection. Scheduling is available Monday through Friday, 8:00 A.M. to 4:30 P.M. at 952-758-4401. If corrections are needed, a minimum of 2 hours must be allowed for re-inspection.
- B. No backfill shall be placed until the work has been inspected and approved.
- C. Any excavation left open for more than 4 hours must be properly fenced or barricaded to protect people and the public from injury.
- D. Contractors are responsible for providing safe trenches and working conditions for their employees and Utility inspectors. No inspection will be conducted until these conditions are met.
- E. Penalty: Any service line covered before inspection or failing to comply with a correction order will be disconnected until corrections are made.

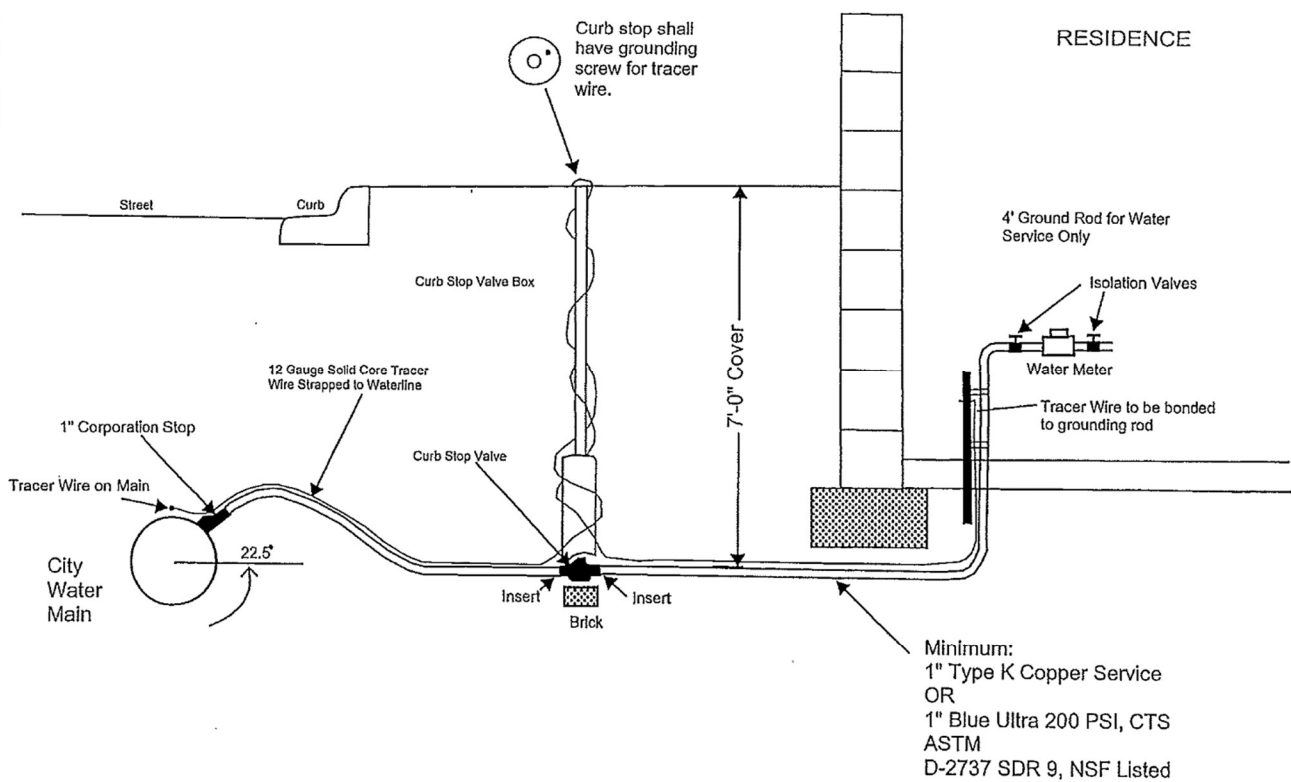

\* All plastic lines through the concrete floor shall be in a vertical position. Line and tracer wire shall be strapped to the provided grounding rod to maintain the vertical position.

Corporation Stop Mueller H-15000 Ford FB1000 A.Y. McDonald 4701	Curb Stop Mueller H-15154 Ford B44-P3 A.Y. McDonald 6104	Curb Box Mueller H-10300 Ford EM 2-75-57 A.Y. McDonald 5615
--	---	--

- NOTES:**
1. Curb box shall NOT have a stationary rod
  2. Curb box shall extend from 78" to 90".
  3. Service shall be bedded in granular borrow.
  4. If curb stop is in driveway, contractor must install FORD A-1 casting, marked with "WATER" on lid.



STANDARD DETAILS

Last Revision:  
DECEMBER 2013

NEW PRAGUE, MINNESOTA

City Plate No.  
SER-2



# Tracer Wire Services

Product Application

06/2005

## Tracer Wire Services

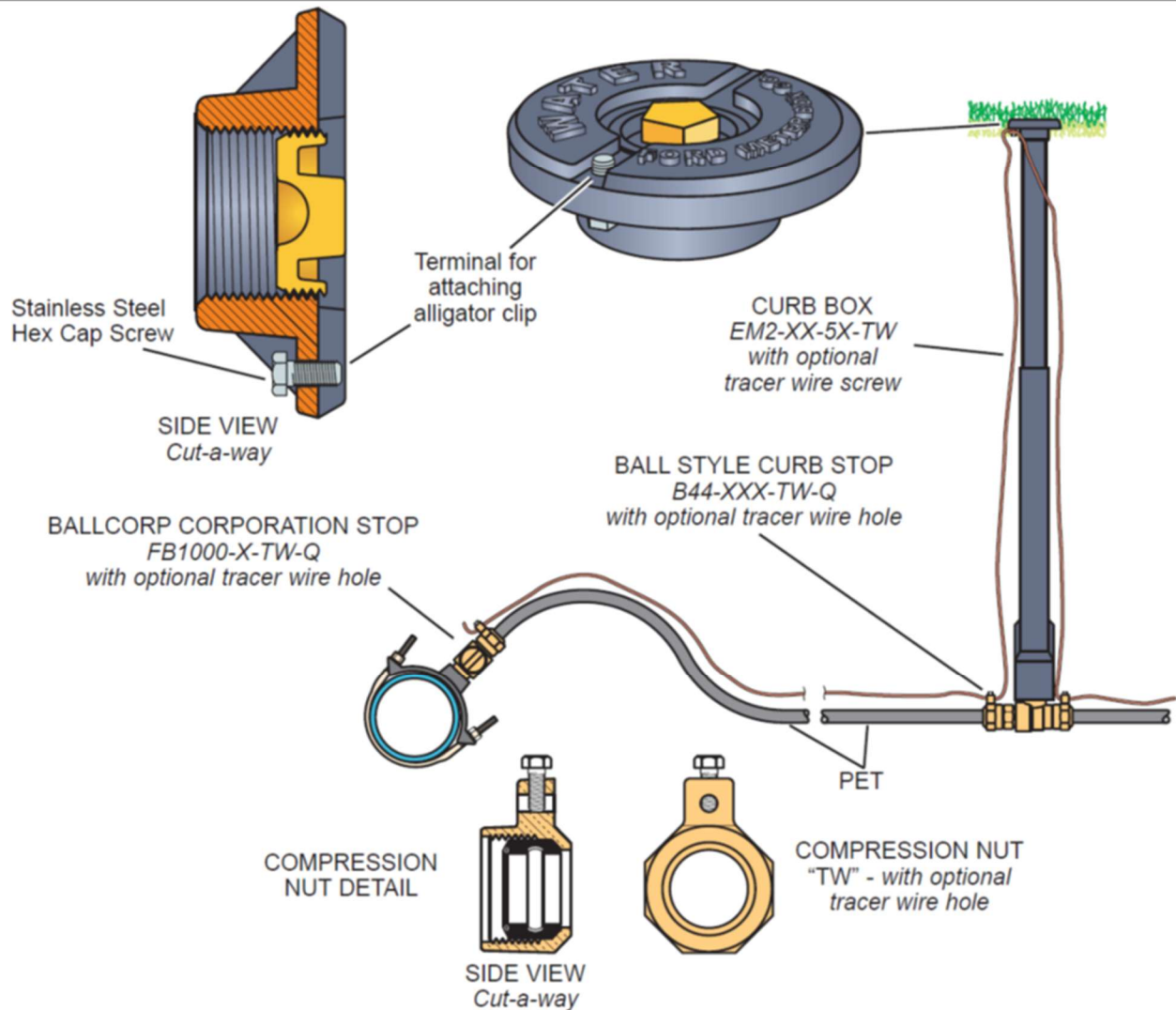

The use of a tracer wire for locating plastic water lines is very popular among water distribution operators. Ford Meter Box makes it easy to install a tracer wire by offering compression nuts and curb box lids for securing the wire. Ford's Quick Joint products for CTS plastic tubing are available with an optional tracer wire hole that has a set screw for a positive connection. Curb Box lids are also available with a tracer wire screw that is tapped into the bottom of the lid for securing a quick connect eyelet terminal. Once tightened, the threaded end of the screw becomes accessible for attaching an alligator clip at the top of the lid. For more information contact your local Ford distributor or The Ford Meter Box Company, Inc.



**The Ford Meter Box Co., Inc.** 775 Manchester Avenue, P.O. Box 443, Wabash, Indiana, USA 46992-0443  
Telephone: 260-563-3171 FAX: 800-826-3487 Overseas FAX: 260-563-0167 <http://www.fordmeterbox.com>

FTW